

## SMA Female to Female to Female adaptor (SMA jack to jack to jack ADP)

P.N. : B11-A2210-31



### Electrical specification

Item	Specification
Frequency range	DC ~ 10 GHz
Impedance (Nominal)	50Ω
V.S.W.R (Max)	2.50 : 1
Connector type	SMA female – female – female
RoHS	Compliance

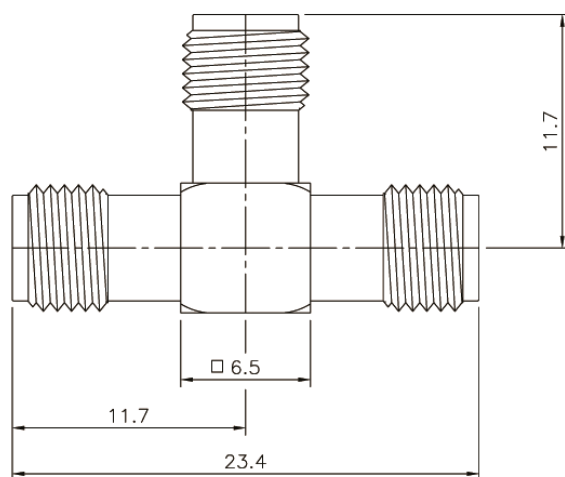

### Material specification

Item	Specification
Body	Brass / Gold plating
Center contact (pin)	Be - Cu / Gold plating
Insulator	PTFE

### Electrical performance

